

## Power supply unit for high pressure lamps (PSU) in safety class II with built-in capacitor and ignitor



similar to

**Series 5106 35 – 250 W** *tw 130* **safety class II**  
**Cross section (W x H) 82 x 73 mm** **EEL = A2**  
**Resin encapsulated and vacuum-impregnated IP 65**  
*All types in various input voltages and 60 Hz version available on request*  
**PSU with no ignitor also available**



**EN 61347-1**  
**EN 61347-2-9**  
**EN 60923**

### Technical facts

Pos.	lamp			power supply unit								
	type	power	current	Ref.-Nr.	description	voltage	$\Delta T$ [°K]	mains current	"L" [mm]	"LA" [mm]	weight about	ignition [kV]
1	HS/HI	35 W	0,53 A	5106.0340.024	HIS 35V-66.50H-34TS	230-240V /50Hz	50	0,22 A	251	221	2,28 kg	4-5
2	HS	50 W	0,76 A	5106.0340.025	HS 50V-66.60H-34TS	230-240V /50Hz	60	0,22 A	251	221	2,28 kg	4-5
3	HS/HI	70 W	1,0 A	5106.0450.005	HIS 70V-66.65H-34TS	230-240V /50Hz	65	0,37 A	262	232	2,58 kg	4-5
4	HS/HI	100 W	1,2 A	5106.0700.006	HIS 100V-66.60H-34TS	230-240V /50Hz	60	0,60 A	287	257	3,28 kg	4-5
5	HS/HI	150 W	1,8 A	5106.0900.006	HIS 150V-66.60H-34TS	230-240V /50Hz	60	0,75 A	307	277	3,98 kg	4-5
6	HS/HI	250 W	3,0 A	5106.1200.001	HIS 250V-66.75H-3 TS	230V / 50 Hz	75	1,40 A	337	307	5,10 kg	no ignit.

### technical notes:

- Load capacity 20-100pF
- Capacitor and ignitor can be replaced
- Terminal 6 x 6 mm<sup>2</sup> without wire protection
- Capacitor with break action mechanism
- with self-resetting temperature switch

### installation instructions:

- Distances from side walls min. 3mm
- M16 x 1,5 cable glands for cable diameter 3,5-10mm

### dimensions:

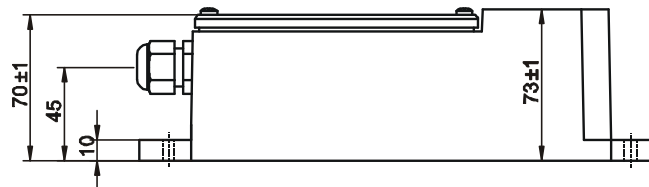
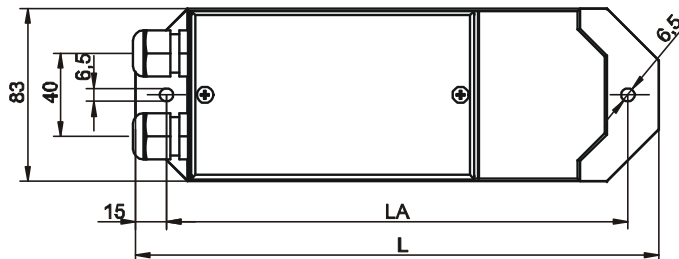

### wiring:

